

Tax Payment Available

Pay Taxes

Property Information

| | | | |
|--------------|--|---------------|------------------------------|
| Property ID | 430-26189-0-0000 | Property Use | 100 - RESIDENTIAL |
| Tax Year | 2023  | Land Use | 113 - SINGLE FAMILY DWELLING |
| Township | 430 Martic Twp | Tax Status | Taxable |
| Site Address | 1111 PENNSY RD | Clean & Green | No |

Property Sketches & Photos

1-1

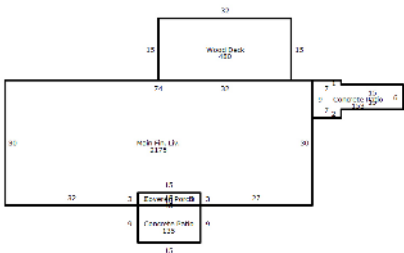

Parcel photo



Related Names

| | |
|--------------|---|
| Parcel Owner | HOFFMAN HAROLD E & PATRICIA M, 1111 PENNSY ROAD PEQUEA, PA 17565 |
| Status | Current |

Assessments

Annual Billing

| | Land | Building | Total | Pref. Land | Pref. Building | Pref. Total |
|--------------|---------------|----------------|----------------|------------|----------------|-------------|
| Non-Exempt | 67,900 | 135,000 | 202,900 | 0 | 0 | 0 |
| Exempt | 0 | 0 | 0 | 0 | 0 | 0 |
| Total | 67,900 | 135,000 | 202,900 | 0 | 0 | 0 |

Note: Preferential assessment values are used for taxation when preferential values are greater than zero.

Property Characteristics

| Electric | Gas | Sewage | Water |
|-----------|------|--------|-------|
| HOOKED-UP | NONE | SEPTIC | WELL |

Market Land Valuation

| Property Type | Land Type | Sq. Ft. | Calc. Acres |
|-------------------|----------------------|---------|-------------|
| RES - Residential | 2 - PRIMARY HOMESITE | 43,560 | 1.0000 |

Structure 1 of 2

| Property Type | Description | Style | Total Living Area | Year Built |
|-------------------|-------------|-----------|-------------------|------------|
| RES - Residential | RANCH #1 | One Story | 2,175 | 1970 |

Accommodations

| | |
|--------------------|---|
| Extra Fixtures | 3 |
| Full Baths | 2 |
| Number of Bedrooms | 4 |
| Number of Families | 1 |
| Number of Rooms | 7 |

Heating/Cooling

| | |
|-----------------------|----------------|
| Electric Baseboard | 2175.00 Sq.Ft. |
| Wall Air Conditioners | 1.00 Units |

Porches, Decks, Breezeways

| | |
|----------------------|---------------|
| Slab Porch with Roof | 45.00 Sq.Ft. |
| Wood Deck | 480.00 Sq.Ft. |

Style

| | |
|-------|-------|
| Style | RANCH |
|-------|-------|

Exterior Walls

| | |
|------------------------------|----------------|
| Frame, Plywood or Hardboard | 1088.00 Sq.Ft. |
| Masonry, Face Brick or Stone | 1088.00 Sq.Ft. |

Fireplaces

| | |
|--------------------------|------------|
| Single 1-Story Fireplace | 1.00 Units |
|--------------------------|------------|

Fuel Type

| | |
|-----------|----------|
| Fuel Type | Electric |
|-----------|----------|

Paving/Decking

| | |
|--|---------------|
| Concrete, Unreinforced Hand Mixed and Spread | 288.00 Sq.Ft. |
|--|---------------|

Roofing

| | |
|---------------------|----------------|
| Composition Shingle | 2175.00 Sq.Ft. |
|---------------------|----------------|

Story Height

| | |
|-------------------|------|
| Number of Stories | 1.00 |
|-------------------|------|

Structure 2 of 2

| Property Type | Description | Style | Total Living Area | Year Built |
|-------------------|-----------------------|--------------|-------------------|------------|
| RES - Residential | Detached Structure #1 | Outbuildings | 132 | 1980 |

Sheds

| | |
|------------------------------------|-------------------|
| 069-04 - Storage Shed - Wood Frame | 132.00 Square Ft. |
|------------------------------------|-------------------|

Exemptions

| Exemption Type | Status | Farmstead |
|----------------|----------------------|-----------|
| Homestead | Appl Approved (Full) | No |

Sales History

| Year | Document # | Sale Type | Sale Date | Sold By | Sold To | Price |
|------|------------|-----------|-----------|---------|---------|-------|
| 1984 | A-900494 | | 8/31/1984 | | | \$0 |

Billing

**NOT CERTIFIED -
PAID RECEIPT Treasurer of Lancaster County**

| Billing Pd. | Tax Billed | Discount/Pen. | Total Billed | Total Paid | Balance Due | Date Paid |
|-------------|------------|---------------|--------------|------------|-------------|-----------|
| January | \$694.12 | (\$13.88) | \$680.24 | \$680.24 | \$0.00 | 2/21/2023 |

Note: Payment amounts may only reflect the Lancaster County amounts

Tax Amounts - January - Billing Number: 2023430000570

| Fund Desc. | Rate Type | Tax Rate | 2% Discount if paid by 4/30/2023 | Base Tax if paid by 6/30/2023 | 10% Penalty if paid after 6/30/2023 |
|---------------------|------------------|-----------------|---|--|--|
| Martic Twp | Millage | 0.51000000 | \$101.41 | \$103.48 | \$113.83 |
| Lancaster County | Millage | 2.91100000 | \$578.83 | \$590.64 | \$649.70 |
| Total | | | \$680.24 | \$694.12 | \$763.53 |

Contact Information

Mail current year, county & municipal real estate tax payments to...

Lancaster County Treasurer
County & Municipal Tax Bill
P.O. Box 3894
LANCASTER, PA 17604
(717) 299-8222

Tax certification **OVERNIGHT requests can be sent to...**

Lancaster County Treasurer
150 North Queen Street, Suite 122
Lancaster, PA 17603

Regular Mail

Lancaster County Treasurer
P.O. Box 1447
Lancaster, PA 17608

No Delinquent Taxes