

**Tax Payment Available**

[Pay Taxes](#)

**Property Information**

<b>Property ID</b>	320-73413-0-0000	<b>Property Use</b>	100 - RESIDENTIAL
<b>Tax Year</b>	2024 <input type="button" value="v"/>	<b>Land Use</b>	113 - SINGLE FAMILY DWELLING
<b>Township</b>	320 West Lampeter Twp	<b>Tax Status</b>	Taxable
<b>Site Address</b>	1928 WILLOW STREET PIKE	<b>Clean &amp; Green</b>	No

**Property Sketches & Photos**

1-1

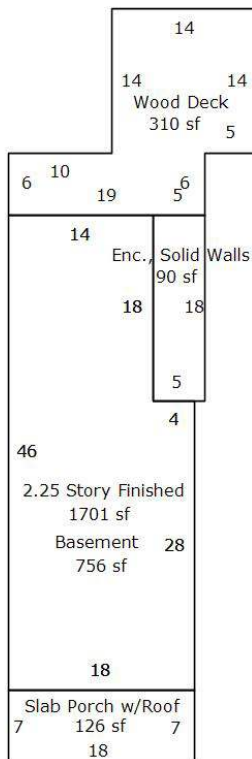

Parcel photo



Related Names	
<b>Parcel Owner</b>	SMITH EDWARD D & BARBARA L, 1928 WILLOW STREET PIKE LANCASTER, PA 17602
<b>Status</b>	Current

Assessments						
Annual Billing						
	Land	Building	Total	Pref. Land	Pref. Building	Pref. Total
Non-Exempt	55,600	117,300	<b>172,900</b>	0	0	<b>0</b>
Exempt	0	0	<b>0</b>	0	0	<b>0</b>
<b>Total</b>	<b>55,600</b>	<b>117,300</b>	<b>172,900</b>	<b>0</b>	<b>0</b>	<b>0</b>
<b>Note:</b> Preferential assessment values are used for taxation when preferential values are greater than zero.						

Property Characteristics			
Electric	Gas	Sewage	Water
HOOKED-UP	NONE	PUBLIC SYSTEM	PUBLIC SYSTEM

Market Land Valuation			
Property Type	Land Type	Sq. Ft.	Calc. Acres
RES - Residential	2 - PRIMARY HOMESITE	9,148	0.2100

Structure 1 of 4

Property Type	Description	Style	Total Living Area	Year Built
RES - Residential	Duplex #1	2 1/2 Story Finished	1,701	1910

Accommodations	
Extra Fixtures	2
Full Baths	1
Half Baths	1
Number of Bedrooms	3
Number of Families	1
Number of Rooms	8

Heating/Cooling	
Radiators, Hot Water	1701.00 Sq.Ft.

Roofing	
Composition Shingle	1701.00 Sq.Ft.

Rounded to the Nearest \$10	
Rounded to the Nearest \$10	119440.00 (\$)

Style	
Style	DUPLEX

Basement	
Minimal Finish Area	252.00 Sq.Ft.
Total Basement Area	756.00 Sq.Ft.

Exterior Walls	
Masonry, Common Brick	1701.00 Sq.Ft.

Fuel Type	
Fuel Type	Oil

Porches, Decks, Breezeways	
Enclosed Porch, Solid Walls	90.00 Sq.Ft.
Slab Porch with Roof	126.00 Sq.Ft.
Wood Deck	310.00 Sq.Ft.

Story Height	
Number of Stories	2.25

Structure 2 of 4				
Property Type	Description	Style	Total Living Area	Year Built
RES - Residential	Detached Structure #1	Outbuildings	792	1987

Garages	
030 - Frame Garage	792.00 Square Ft.

Structure 3 of 4				
Property Type	Description	Style	Total Living Area	Year Built
RES - Residential	Detached Structure #2	Outbuildings	120	1987

Sheds	
069-04 - Storage Shed - Wood Frame	120.00 Square Ft.

Structure 4 of 4				
Property Type	Description	Style	Total Living Area	Year Built
RES - Residential	Detached Structure #3	Outbuildings	120	1910

Sheds	
069-04 - Storage Shed - Wood Frame	120.00 Square Ft.

Exemptions		
Exemption Type	Status	Farmstead
Homestead	Appl Approved (Full)	No

Sales History						
Year	Document #	Sale Type	Sale Date	Sold By	Sold To	Price
1900	A-591002		1/1/1900			\$0

Billing						
NOT CERTIFIED - PAID RECEIPT Treasurer of Lancaster County						
Billing Pd.	Tax Billed	Discount/Pen.	Total Billed	Total Paid	Balance Due	Date Paid
January	\$719.44	(\$14.39)	\$705.05	\$705.05	\$0.00	5/3/2024
<b>Note:</b> Payment amounts may only reflect the Lancaster County amounts						

Tax Amounts - January - Billing Number: 2024320003879					
Fund Desc.	Rate Type	Tax Rate	2% Discount if paid by 4/30/2024	Base Tax if paid by 6/30/2024	10% Penalty if paid after 6/30/2024
Lancaster County	Millage	2.91100000	\$493.24	\$503.31	\$553.64
West Lampeter Twp	Millage	1.25000000	\$211.81	\$216.13	\$237.74
<b>Total</b>			<b>\$705.05</b>	<b>\$719.44</b>	<b>\$791.38</b>

## Contact Information

Mail current year, county & municipal real estate tax payments to...

Lancaster County Treasurer  
County & Municipal Tax Bill  
P.O. Box 3894  
LANCASTER, PA 17604  
(717) 299-8222

Tax certification **OVERNIGHT** requests can be sent to...

Lancaster County Treasurer  
150 North Queen Street, Suite 122  
Lancaster, PA 17603

Regular Mail

Lancaster County Treasurer  
P.O. Box 1447  
Lancaster, PA 17608

## No Delinquent Taxes

© 2024 DEVNET, Inc

Data updated: 2024-08-15 17:15:00

wEdge Version 4.0.8755.27488

Assembly Date: 2023/12/21