

Tax Payment Available

[Pay Taxes](#)

Property Information

Property ID	300-93893-0-0000	Property Use	100 - RESIDENTIAL
Tax Year	2024 <input type="button" value="v"/>	Land Use	113 - SINGLE FAMILY DWELLING
Township	300 West Hempfield Twp	Tax Status	Taxable
Site Address	4000 MARIETTA AVE	Clean & Green	No

Property Sketches & Photos

1-1

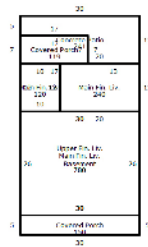

Parcel photo



Related Names

Parcel Owner	BAIR N ALAN & SALLY B, 4000 MARIETTA AVENUE COLUMBIA, PA 17512
Status	Current

Assessments

Annual Billing

	Land	Building	Total	Pref. Land	Pref. Building	Pref. Total
Non-Exempt	65,400	131,200	196,600	0	0	0
Exempt	0	0	0	0	0	0
Total	65,400	131,200	196,600	0	0	0

Note: Preferential assessment values are used for taxation when preferential values are greater than zero.

Property Characteristics

Electric	Gas	Sewage	Water
HOOKED-UP	NONE	PUBLIC SYSTEM	PUBLIC SYSTEM

Market Land Valuation

Property Type	Land Type	Sq. Ft.	Calc. Acres
RES - Residential	2 - PRIMARY HOMESITE	39,640	0.9100

Structure 1 of 5

Property Type	Description	Style	Total Living Area	Year Built
RES - Residential	CONVENTIONAL #1	Two Story	1,920	1830

Accommodations	
Extra Fixtures	2
Full Baths	1
Half Baths	1
Number of Bedrooms	4
Number of Families	1
Number of Rooms	8
Permanent Stairs	Yes

Miscellaneous Non-Residence	
PERM-STAIRS	1.00 Units

Porches, Decks, Breezeways	
Slab Porch with Roof	269.00 Sq.Ft.

Story Height	
Number of Stories	2.00

Basement	
Total Basement Area	780.00 Sq.Ft.

Exterior Walls	
Frame, Siding, Metal	1920.00 Sq.Ft.

Fuel Type	
Fuel Type	Oil

Heating/Cooling	
Radiators, Hot Water	1920.00 Sq.Ft.

Paving/Decking	
Concrete, Unreinforced Hand Mixed and Spread	241.00 Sq.Ft.

Roofing	
Metal, Preformed	1920.00 Sq.Ft.

Style	
Style	CONVENTIONAL

Structure 2 of 5

Property Type	Description	Style	Total Living Area	Year Built
RES - Residential	Detached Structure #1	Outbuildings	1,152	1940

Barns	
033-04 - Genrl Purp Barn - Wood Frame	1152.00 Square Ft.

Structure 3 of 5

Property Type	Description	Style	Total Living Area	Year Built
RES - Residential	Detached Structure #2	Outbuildings	320	1940

Sheds	
069-04 - Storage Shed - Wood Frame	320.00 Square Ft.

Structure 4 of 5

Property Type	Description	Style	Total Living Area	Year Built
RES - Residential	Detached Structure #3	Outbuildings	576	2012

Garages	
030 - Frame Garage	576.00 Square Ft.

Structure 5 of 5

Property Type	Description	Style	Total Living Area	Year Built
RES - Residential	Detached Structure #4	One Story	0	2020

Other / Miscellaneous	
032 - Gazebo	80.00 Square Ft.

Exemptions

Exemption Type	Status	Farmstead
Homestead	Appl Approved (Full)	No

Sales History

Year	Document #	Sale Type	Sale Date	Sold By	Sold To	Price
1977	H-71-400		6/28/1977			\$0

Billing

**NOT CERTIFIED -
PAID RECEIPT Treasurer of Lancaster County**

Billing Pd.	Tax Billed	Discount/Pen.	Total Billed	Total Paid	Balance Due	Date Paid
January	\$955.67	(\$19.12)	\$936.55	\$936.55	\$0.00	3/1/2024

Note: Payment amounts may only reflect the Lancaster County amounts

Tax Amounts - January - Billing Number: 2024300005743

Fund Desc.	Rate Type	Tax Rate	2% Discount if paid by 4/30/2024	Base Tax if paid by 6/30/2024	10% Penalty if paid after 6/30/2024
Lancaster County	Millage	2.91100000	\$560.85	\$572.30	\$629.53
West Hempfield Twp	Millage	1.95000000	\$375.70	\$383.37	\$421.71
Total			\$936.55	\$955.67	\$1,051.24

Contact Information

Mail current year, county & municipal real estate tax payments to...

Lancaster County Treasurer
 County & Municipal Tax Bill
 P.O. Box 3894
 LANCASTER, PA 17604
 (717) 299-8222

Tax certification **OVERNIGHT** requests can be sent to...

Lancaster County Treasurer
 150 North Queen Street, Suite 122
 Lancaster, PA 17603

Regular Mail

Lancaster County Treasurer
 P.O. Box 1447
 Lancaster, PA 17608

No Delinquent Taxes