

**Tax Payment Available**

[Pay Taxes](#)

**Property Information**

**Property ID** 320-05654-0-0000  
**Tax Year** 2023   
**Township** 320 West Lampeter Twp  
**Site Address** 213 FANNIE AVE

**Property Use** 100 - RESIDENTIAL  
**Land Use** 113 - SINGLE FAMILY DWELLING  
**Tax Status** Taxable  
**Clean & Green** No

**Property Sketches & Photos**

1-1

Parcel photo

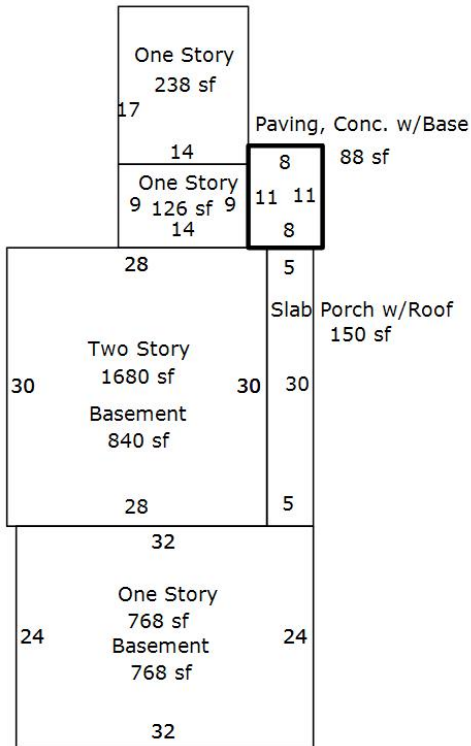

Related Names

**Parcel Owner** 213 FANNIE AVE LLC,  
213 FANNIE AVENUE  
LANCASTER, PA 17602

**Status** Current

Assessments

Annual Billing

	Land	Building	Total	Pref. Land	Pref. Building	Pref. Total
Non-Exempt	102,400	144,400	<b>246,800</b>	0	0	<b>0</b>
Exempt	0	0	<b>0</b>	0	0	<b>0</b>
<b>Total</b>	<b>102,400</b>	<b>144,400</b>	<b>246,800</b>	<b>0</b>	<b>0</b>	<b>0</b>

**Note:** Preferential assessment values are used for taxation when preferential values are greater than zero.

Property Characteristics

Electric	Gas	Sewage	Water
HOOKED-UP	NONE	PUBLIC SYSTEM	WELL

Market Land Valuation

Property Type	Land Type	Sq. Ft.	Calc. Acres
RES - Residential	2 - PRIMARY HOMESITE	43,560	1.0000
RES - Residential	6 - RESIDUAL	121,968	2.8000

Structure 1 of 5

Property Type	Description	Style	Total Living Area	Year Built
RES - Residential	CONVENTIONAL #1	Two Story	2,812	1880

Accommodations	
Extra Fixtures	2
Full Baths	2
Number of Bedrooms	3
Number of Families	1
Number of Rooms	6

Fuel Type	
Fuel Type	Oil

Miscellaneous Non-Residence	
02AT-AVG	1.00 Units

Porches, Decks, Breezeways	
Slab Porch with Roof	150.00 Sq.Ft.

Story Height	
Number of Stories	2.00

Basement	
Total Basement Area	1608.00 Sq.Ft.

Exterior Walls	
Frame, Siding, Metal	2812.00 Sq.Ft.

Fireplaces	
Single 2-Story Fireplace	1.00 Units

Heating/Cooling	
Add for Oil Fired	2812.00 Sq.Ft.
Forced Air Furnace	2812.00 Sq.Ft.

Paving/Decking	
Concrete, Unreinforced Hand Mixed and Spread	88.00 Sq.Ft.

Roofing	
Composition Shingle	2812.00 Sq.Ft.

Style	
Style	CONVENTIONAL

Structure 2 of 5

Property Type	Description	Style	Total Living Area	Year Built
RES - Residential	Detached Structure #1	Outbuildings	460	1900

Garages	
030 - Frame Garage	460.00 Square Ft.

Structure 3 of 5

Property Type	Description	Style	Total Living Area	Year Built
RES - Residential	Detached Structure #3	Outbuildings	1,040	1900

Garages	
017 - Concrete Block Garage	1040.00 Square Ft.

Structure 4 of 5

Property Type	Description	Style	Total Living Area	Year Built
RES - Residential	Detached Structure #4	Outbuildings	1,419	1900

Barns	
001-04 - Bank Barn - Wood Frame	1419.00 Square Ft.

Structure 5 of 5

Property Type	Description	Style	Total Living Area	Year Built
RES - Residential	Detached Structure #5	Outbuildings	288	1900

Other / Miscellaneous	
100-04 - Pavillion - Wood Frame	288.00 Square Ft.

Exemptions

Exemption Type	Status	Farmstead
Homestead	Exemption Expired	No

Sales History

Year	Document #	Sale Type	Sale Date	Sold By	Sold To	Price
2023	6740628	DEED	6/16/2023	ANNA MANSON	213 FANNIE AVE LLC	\$230,000
1900	T-740530		1/1/1900			\$0

Billing

**NOT A CERTIFIED COPY - FOR INFORMATIONAL PURPOSES ONLY**

Billing Pd.	Tax Billed	Discount/Pen.	Total Billed	Total Paid	Balance Due	Date Paid
January	\$1,002.25	\$0.00	\$1,002.25	\$1,002.25	\$0.00	6/27/2023

**Note:** Payment amounts may only reflect the Lancaster County amounts

## Tax Amounts - January

Fund Desc.	Rate Type	Tax Rate	2% Discount if paid by 4/30/2023	Base Tax if paid by 6/30/2023	10% Penalty if paid after 6/30/2023
West Lampeter Twp	Millage	1.15000000	\$278.14	\$283.82	\$312.20
Lancaster County	Millage	2.91100000	\$704.06	\$718.43	\$790.27
<b>Total</b>			<b>\$982.20</b>	<b>\$1,002.25</b>	<b>\$1,102.47</b>

## Contact Information

Mail current year, county & municipal real estate tax payments to...

Lancaster County Treasurer  
County & Municipal Tax Bill  
P.O. Box 3894  
LANCASTER, PA 17604  
(717) 299-8222

Tax certification **OVERNIGHT** requests can be sent to...

Lancaster County Treasurer  
150 North Queen Street, Suite 122  
Lancaster, PA 17603

### Regular Mail

Lancaster County Treasurer  
P.O. Box 1447  
Lancaster, PA 17608

## No Delinquent Taxes